

PROFILE
Scale: 1" = 10'

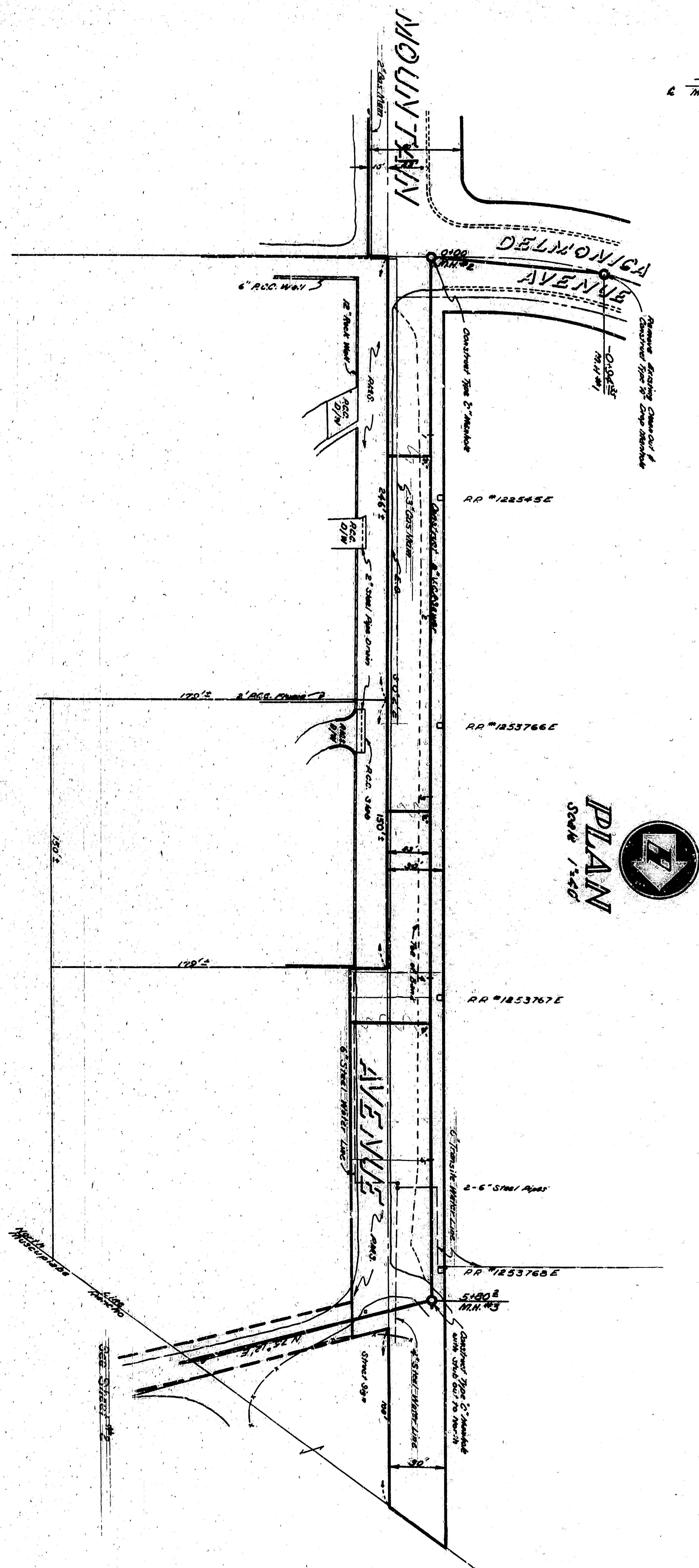

PLAN
Scale: 1" = 40'

GENERAL NOTES

1. All work shall be done in accordance with the City of San Bernardino Specifications for Sewerage and Sanitation, 1940 Edition.
2. All work shall be done in accordance with the City of San Bernardino Specifications for Sewerage and Sanitation, 1940 Edition.
3. All work shall be done in accordance with the City of San Bernardino Specifications for Sewerage and Sanitation, 1940 Edition.
4. All work shall be done in accordance with the City of San Bernardino Specifications for Sewerage and Sanitation, 1940 Edition.
5. All work shall be done in accordance with the City of San Bernardino Specifications for Sewerage and Sanitation, 1940 Edition.
6. All work shall be done in accordance with the City of San Bernardino Specifications for Sewerage and Sanitation, 1940 Edition.
7. All work shall be done in accordance with the City of San Bernardino Specifications for Sewerage and Sanitation, 1940 Edition.
8. All work shall be done in accordance with the City of San Bernardino Specifications for Sewerage and Sanitation, 1940 Edition.
9. All work shall be done in accordance with the City of San Bernardino Specifications for Sewerage and Sanitation, 1940 Edition.
10. All work shall be done in accordance with the City of San Bernardino Specifications for Sewerage and Sanitation, 1940 Edition.

APPROVED	CITY ENGINEER	15
DRAWING NO. 154533	REGISTERED CIVIL ENGINEER NO. 154533	
SHEET 1 OF 1	DRAWN BY [Signature]	
	CHECKED BY [Signature]	
	RECOMMENDED	

DEPARTMENT OF ENGINEERING
CITY OF SAN BERNARDINO
MOUNTAIN AVENUE
SANITATION DISTRICT

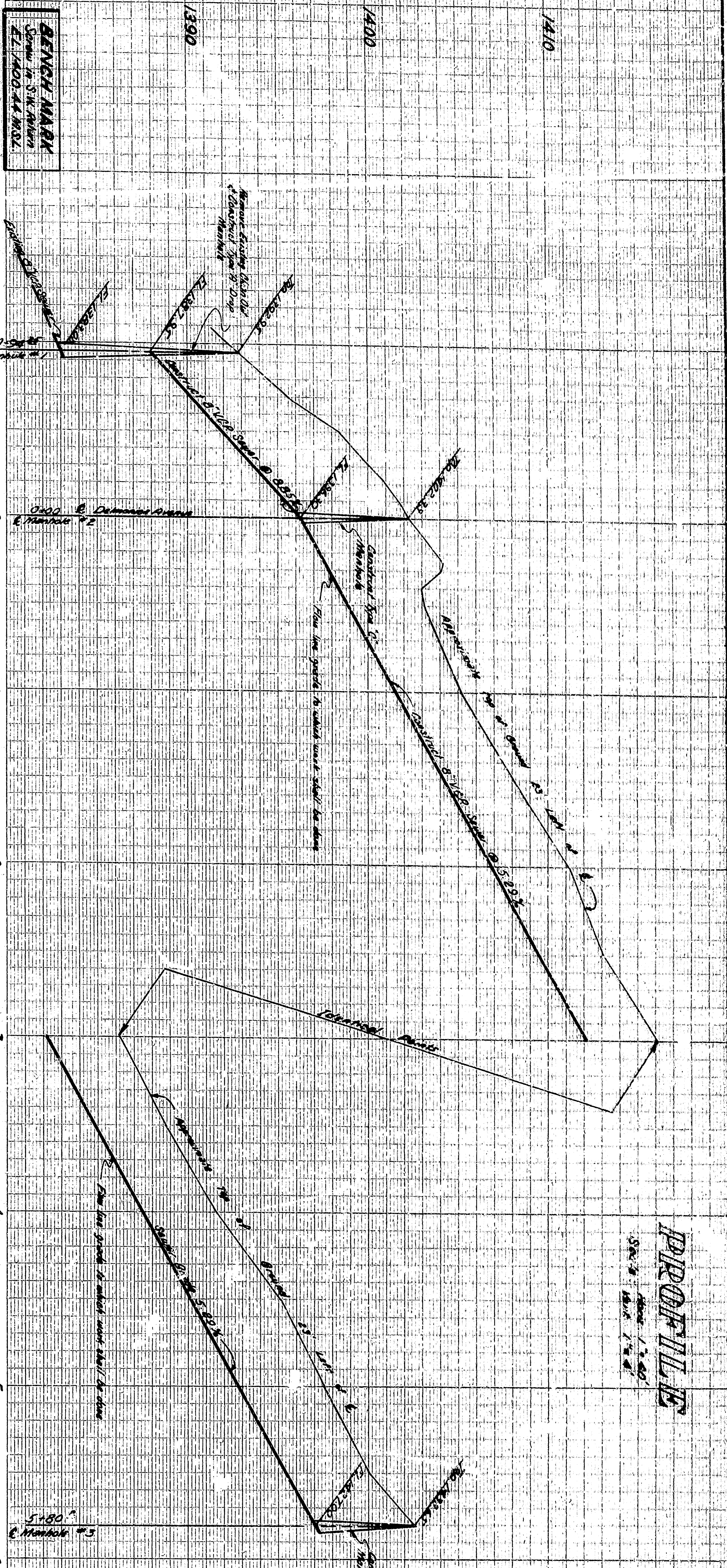

PROFILE
Scale: 1" = 10'

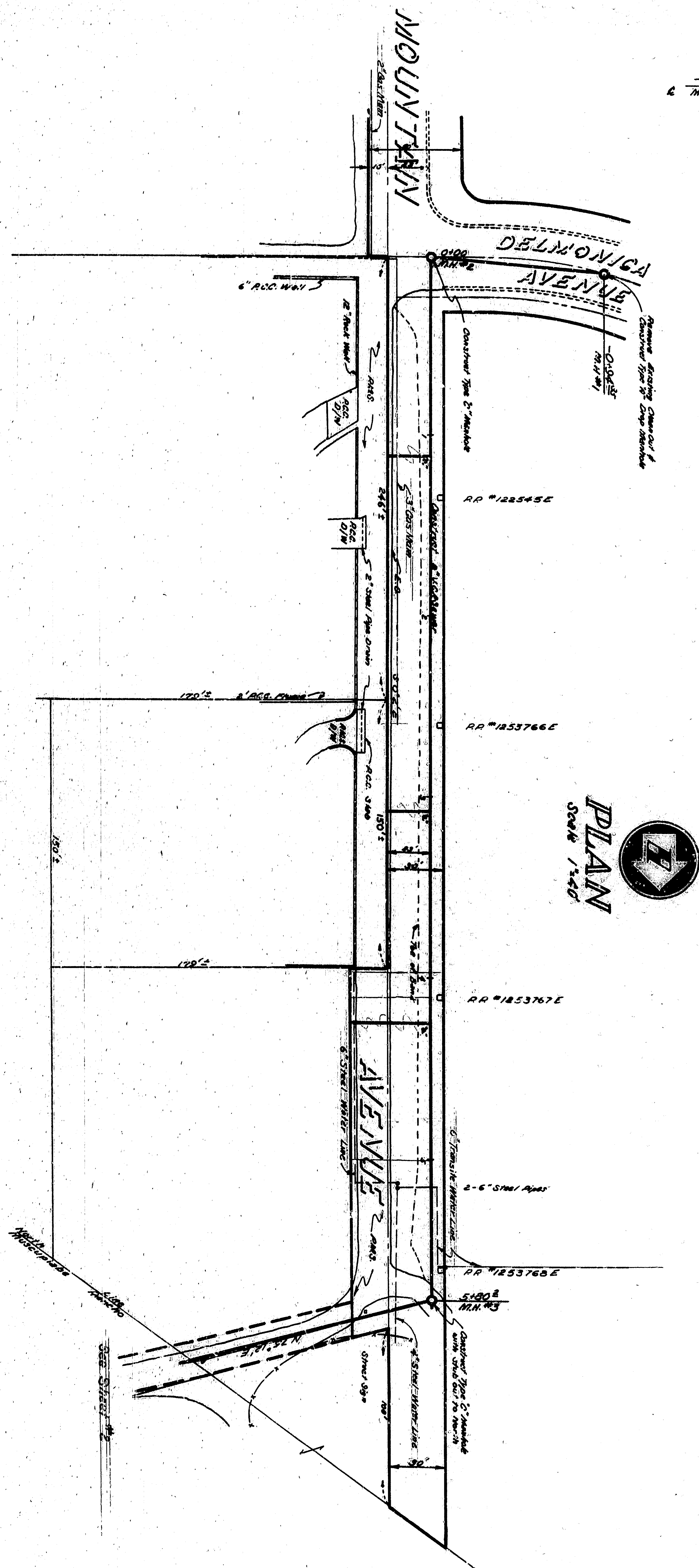

PLAN
Scale: 1" = 40'

GENERAL NOTES

1. All work shall be in accordance with the City of San Bernardino Specifications for Sewerage and Sanitation, 1958 Edition.
2. All utility lines shown on this plan shall be as shown on the City of San Bernardino Utility Maps, 1958 Edition.
3. The proposed sewer line shall be installed in accordance with the City of San Bernardino Specifications for Sewerage and Sanitation, 1958 Edition.
4. All pipe shall be 12" diameter vitrified clay pipe, 15' length, with 1/4" thick walls, and shall be installed in accordance with the City of San Bernardino Specifications for Sewerage and Sanitation, 1958 Edition.
5. All manholes shall be 48" diameter, 4' high, and shall be installed in accordance with the City of San Bernardino Specifications for Sewerage and Sanitation, 1958 Edition.
6. The proposed sewer line shall be installed in accordance with the City of San Bernardino Specifications for Sewerage and Sanitation, 1958 Edition.
7. The proposed sewer line shall be installed in accordance with the City of San Bernardino Specifications for Sewerage and Sanitation, 1958 Edition.
8. The proposed sewer line shall be installed in accordance with the City of San Bernardino Specifications for Sewerage and Sanitation, 1958 Edition.
9. The proposed sewer line shall be installed in accordance with the City of San Bernardino Specifications for Sewerage and Sanitation, 1958 Edition.
10. The proposed sewer line shall be installed in accordance with the City of San Bernardino Specifications for Sewerage and Sanitation, 1958 Edition.

APPROVED	CITY ENGINEER	15
DRAWING NO.	REGISTERED CIVIL ENGINEER NO. 158433	
SHEET 1 OF 6	DRAWN BY: [Signature]	
	CHECKED BY:	
	RECOMMENDED	

DEPARTMENT OF ENGINEERING
CITY OF SAN BERNARDINO
**MOUNTAIN AVENUE
SANITATION DISTRICT**